

EC HOISTS for SPECIAL APPLICATIONS

MODEL EC Turnover Hoists



EC Turnover Model Hoists

COFFING EC Turnover Models - Specially modified EC Hoist designed for machining, assembly, or repair applications which require complete rotation and/or precise positioning of large, non-symmetrical work pieces.

CAPACITIES & LIFTS - Rated loads from 1/4 to 4 Tons. Lift stroke is 15-foot standard. Consult factory for longer lift strokes.

VOLTAGE - 230/460, three phase motors standard. Consult factory for other voltages and two speed motors.

SUSPENSION OPTIONS - Rigid lug mount only. Allows attachment to load hook of another hoist for vertical lifting.

TWO LOAD HOOKS - Color coded load hooks with corresponding push button for operator convenience.

OPERATION - Load hooks operate in opposite directions.

APPLICATION - Completely inverts virtually any shape load with use of simple slings and successive repositioning of load hooks.

ACCESSORIES - Full line of options to meet a variety of applications. See pages 25-31.

LIFETIME WARRANTY

Typical Application

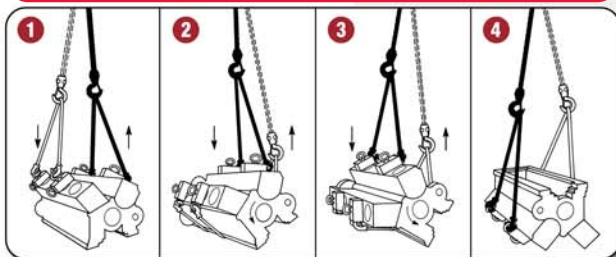

Engine block is raised straight up (1) by special cylinder lift rings, then rotated approximately 45° until one load hook (2) supports total weight. Sling is guided under block and attached to free hook (3). Hoist is then reversed (4) until block is inverted.

EC Turnover Hoists

| Capacity | | | Model Number | Frame * Size | Load Chain Length (ft.) | Lift Stroke (ft.) | Motor HP | Lift Speed (rpm) | Headroom (in.) | Housing Dimensions (in.) | | | Net Wt. ** (lb.) |
|----------|--------|-------|--------------|--------------|-------------------------|-------------------|----------|------------------|----------------|--------------------------|----------|---------|------------------|
| (lb.) | (kg) † | (Ton) | | | | | | | | H | W | L | |
| 500 | 250 | 1/4 | EC-0516-TH | S | 16 | 15 | 1/4 | 16 | 19 7/8 | 9 7/8 | 11 5/8 | 23 3/8 | 120 |
| 1000 | 500 | 1/2 | EC-1016-TH | S | 16 | 15 | 1/2 | 16 | 19 7/8 | 9 7/8 | 11 5/8 | 23 3/8 | 126 |
| 2000 | 1000 | 1 | EC-2016-TH | S | 16 | 15 | 1 | 16 | 19 7/8 | 9 7/8 | 11 5/8 | 23 3/8 | 138 |
| 4000 | 2000 | 2 | EC-4016-TH | L | 16 | 15 | 2 | 16 | 28 1/2 | 12 5/16 | 14 13/16 | 31 3/16 | 325 |
| 6000 | 3000 | 3 | EC-6008-TH | L | 34** | 15 | 3 | 8 | 33 | 13 5/16 | 15 3/8 | 31 3/16 | 385 |
| 8000 | | 4 | EC-8008-TH | L | 34** | 15 | 3 | 8 | 33 | 13 5/16 | 15 3/8 | 31 3/16 | 390 |

† Metric rated option available.

* S = Small frame hoist, single or three phase. L = Large frame hoist, three phase only.

** Each load block is double-chained on 6000 lb. and 8000 lb. models.



1/4 - 4 Ton
Made in USA

