

## CP PILE PITCHING CLAMP

**WORKING LOAD LIMIT: 4,400 TO 11,000 LBS.**

CP Clamps are designed specifically for pitching sheet steel and have the advantage of an attached rope for easy release from the ground.

### BENEFITS & FEATURES

- Designed specifically for pitching sheet steel piling
- Ideal clamp for heavy construction
- Rope is fitted for easy release from the ground
- These are not designed to extract driven piles, use the PP series clamps for this
- Design factor 4:1

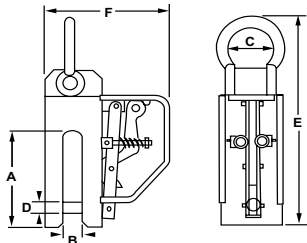

### ▶ INSPECTION, CARE & USE

**DO NOT** use CP Clamps to extract a driven pile. Use the PP series clamps for this application.

For more information, visit us at [www.cmworks.com](http://www.cmworks.com)



Product Code	Working Load Limit (lbs.)	Dimensions (in.)						Weight (lbs.)
		A	B	C	D	E	F	
CP2	4,400	8.976	0.787	2.000	0.787	16.750	8.500	41.9
CP3	6,600	8.976	1.024	2.500	1.181	17.875	8.875	50.7
CP5	11,000	8.976	1.378	3.250	1.181	19.875	9.500	72.8

## TTG HORIZONTAL GIRDER CLAMP

**WORKING LOAD LIMIT: 200 TO 16,500 LBS.**

TTG Clamps are designed to lift and transport structural steel beams in the horizontal position.

### BENEFITS & FEATURES

- Designed to lift and transport structural steel beams in the horizontal position
- Fitted with a Camlok spring-operated safety lock and is operated by pulling the lock upwards
- For short beams, a single clamp can be used. Long beams should be lifted using 2 clamps attached to opposite beam flanges
- Maximum hardness of material to lift should not exceed 300 Brinell (32HRc)
- Design factor 4:1

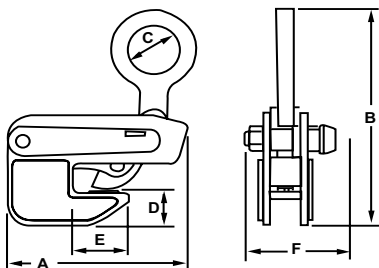

### ▶ INSPECTION, CARE & USE

**DO NOT** lift plates with a temperature greater than 120°C or 250°F

For more information, visit us at [www.cmworks.com](http://www.cmworks.com)

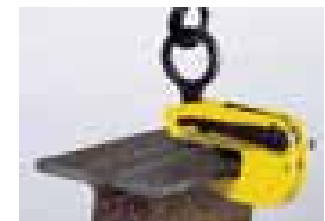

Product Code	Working Load Limit		Plate (in.)	Dimensions (in.)						Weight (lbs.)
	Minimum (lbs.)	Maximum (lbs.)		A	B	C	D	E	F	
TTG1500	200	3,300	0 to 1-1/8	9.000	10.875	3.750	1.750	2.750	4.000	12.1
TTG3000	350	6,600	0 to 1-3/8	11.125	11.625	3.125	2.125	2.875	4.500	24.3
TTG4500*	1,000	9,900	0 to 1-1/2	12.375	13.250	3.500	2.375	3.000	4.625	32.0
TTG7500*	1,650	16,500	0 to 1-3/4	14.500	15.000	4.375	2.500	3.625	6.625	61.7

\*Not Stocked