

BOST-BRONZ Oil-Impregnated Sintered Bronze Bearings

F



BOST-BRONZ is Boston Gear’s all-purpose, oil-impregnated porous bronze bearing material. It is manufactured of highest purity metal powders by the powder metallurgy process. This process provides uniformly distributed pores between the metal particles which absorb oil by capillary action. BOST-BRONZ has a self-contained oil supply (approximately 20% by volume) which provides a uniform, protective film over the entire bearing surface. Composition and physical properties are as follows: –

BOST-BRONZ can be used for production and replacement requirements in practically every known industry. It has proven to be efficient under heavy loads at moderate speeds and also under light loads at high speeds. It is ideally suited for applications where normal lubrication is difficult or impossible to provide.

Coefficient of Friction	
Static	.1 - .3
Dynamic	.02 - .04

Accuracy

The close tolerances of BOST-BRONZ bearings are made possible through expertly controlled manufacturing methods. In addition, the lubricating features of BOST-BRONZ permit reduced shaft clearances — a precision product with precision performance.

Performance

Because of its porous construction, BOST-BRONZ bearings have an oil reservoir when idle — an oil film to start on — an oil film to run on, assuring low starting torque and smooth, quiet positive performance.

Adaptability

BOST-BRONZ bearings are designed for immediate installation and may be used in most applications without additional machining. Oil holes or grooves are not required and turning or boring bearing diameters is normally unnecessary.

Composition %	Density in Grams per Cu. Cent. Impregnated	Tensile Strength Lbs. per Sq. In.	Yield Strength in Compression (0.2% Offset) Lbs. per Sq. In.	Elongation in One Inch %	Porosity by Volume %
Copper (Cu) 87.5-90.5 Iron 1.0 Max. Lead (a) Carbon (Graphite Max.) 1.75 Max. Tin 9.5-10.5 Total Other Elements .05	6.4/6.8	14,000	11,000	1.0	19 Min.
Conforms to ASTM B438-73 Grade 1, Type 2, and SAE-841 Mil-B-5687C TYPE 1 comp A (Ref:Oil is a SAE 20-30 weight)					

(a) Included in other elements

BOST-BRONZ Oil-Impregnated Sintered Bronze Bearings

F

Non-Listed Sizes

The stock sizes of BOST-BRONZ bearings listed in this catalog will satisfy the majority of industrial applications. Tooling is available for many metric and additional inch sizes. Where tooling is not available, special sizes can be made to order.

Special Shapes

Many special shapes can be made economically by the powdered metal process. This process is particularly economical for the production of comparatively simple shapes in large volume. More complicated shapes may also be economical to produce by this process when the savings in machining justify the cost of more expensive tooling.



Special Compositions

In addition to our standard BOST-BRONZ, many special compositions can be furnished on a made-to-order basis.

Applications

BOST-BRONZ bearings can be used on any application where the load-carrying capacity required falls within the capabilities of the material. BOST-BRONZ bearings operate efficiently under heavy loads at slow speeds. Because these bearings are supplied with oil impregnation, the original oil content provides long-lasting lubrication. For even longer life requirements, many applications incorporate impregnated felts or other reservoir techniques about the bearing.

Selection

In general, sleeve bearings should be selected with a length of one to two times the shaft diameter and an O.D. approximately 25% larger than the shaft diameter.

A general guide to determination of limiting load and velocity values for sleeve bearings has been established by the use of PV calculations. PV represents Pressure x Velocity, for example 100 psi x 20 fpm yields a PV of 2000.

Maximum PV values for BOST-BRONZ bearings:

Cylindrical & Flange Bearings - 50,000
Thrust Bearings - 10,000

For complete selection and application information, see Engineering Section, Pages 174-182.

BOST-BRONZ Oil-Impregnated Sintered Bronze Bearings

Plain Cylindrical Bearings

ALL DIMENSIONS IN INCHES
ORDER BY CATALOG NUMBER OR ITEM CODE

F

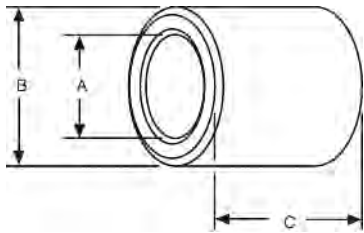

STANDARD TOLERANCES

DIMENSIONS		TOLERANCE
A	1/8 - 1 1/2	+ .000, - .001
	1 3/4 - 2 1/2	+ .000, - .0015
B	2 3/4 - 3 1/2	+ .000, - .002
C	1/8 - 1-1/2	± .005
	1 3/4 - 3	± .0075
	4	± .010

CONCENTRICITY

DIMENSIONS		TOLERANCE
A	1/8 - 1 1/2	.003
	1 5/8 - 3	.004
	3 1/4 - 3 1/2	.005

Prices on unlisted sizes and other Boston Gear powder metal parts provided on request.

A	B	C	Catalog Number	Item Code	A	B	C	Catalog Number	Item Code				
1/8 .127	1/4 .252	1/8	B24-1	34504	3/8 .377	9/16 .5645	3/8	B69-3	34648				
		1/4	B24-2	34506			1/2	B69-4	34650				
		3/8	B24-3	34508			5/8	B69-5	34652				
		1/2	B24-4	34510			3/4	B69-6	34654				
	1/8	B25-1	34512	7/8			B69-7	34656					
3/16 .189	5/16 .315	1/4	B25-2	34514		1	B69-8	34658	1-14	B69-10	34660		
		3/8	B25-3	34516		3/8	B610-3	34676					
		1/2	B25-4	34518		1/2	B610-4	34678					
		5/8	B25-5	34520		5/8	B610-5	34680					
		3/4	B34-2	34522		3/4	B610-6	34682					
	1/4 .252	1/4 .252	1/4	B34-3	34524	7/8	B610-7	34684	1-1/4	1	B610-8	34686	
			3/8	B34-4	34526	1	B610-9	34688					
			1/2	B34-5	34528	3/8	B612-3	34690					
			5/8	B34-6	34530	1/2	B612-4	34692					
			3/4	B35-2	34532	3/4	B612-6	34694					
1/4 .252	5/16 .315	3/8	B35-3	34534	7/16 .439	3/4 .753	1	B612-8	34696				
		1/2	B35-4	34536			1-1/4	B612-10	34698				
		5/8	B35-5	34538			3/8	B79-3	34662				
		3/4	B35-6	34540			1/2	B79-4	34664				
		3/8	B36-3	13561			5/8	B79-5	34666				
	1/4 .252	3/8 .377	1/2	B36-4		13563	3/4	B79-6	34668	9/16 .5645	7/8	B79-7	34670
			5/8	B36-5		13565	1	B79-8	34672				
			3/4	B36-6		13567	1-1/4	B79-10	34674				
			1/4	B45-2		13569	3/8	B710-3	34700				
			3/8	B45-3		13571	1/2	B710-4	34702				
1/4 .252		7/16 .439	1/2	B45-4	13573	5/8	B710-5	34704	5/8 .628	3/4	B710-6	34706	
			3/4	B45-6	13575	7/8	B710-7	34708					
			1/4	B46-2	34542	1	B710-8	34710					
			5/16	B46-2 1/2	34544	1-1/4	B710-10	34712					
			3/8	B46-3	34546	1/2	B711-4	34714					
	1/4 .252	3/8 .377	1/2	B46-4	34548	1	B711-8	34716	5/8 .628	1-1/2	B711-12	34718	
			5/8	B46-5	34550	1/2	B810-4	34720					
			3/4	B46-6	34552	5/8	B810-5	34722					
			7/8	B46-7	34554	3/4	B810-6	34724					
			1	B46-8	34556	7/8	B810-7	34726					
1/4 .252		7/16 .439	1-1/4	B46-10	34558	1	B810-8	34728	11/16 .690	1-1/8	B810-9	34730	
			3/8	B47-3	34560	1-1/4	B810-10	34732					
			1/2	B47-4	34562	1-1/2	B810-12	34734					
			5/8	B47-5	34564	1/2	B811-4	34736					
			3/4	B47-6	34566	5/8	B811-5	34738					
	1/4 .252	1/2 .502	7/8	B47-7	34568	3/4	B811-6	34740	11/16 .690	7/8	B811-7	34742	
			1	B47-8	34570	1	B811-8	34744					
			3/8	B48-3	34572	1-1/8	B811-9	34746					
			1/2	B48-4	34574	1-1/4	B811-10	34748					
			5/8	B48-5	34576	1-1/2	B811-12	34750					
1/4 .252		3/8 .377	3/4	B48-6	34578	1/2 .503	3/4 .753	1/2	B812-4	34752			
			7/8	B48-7	34580			5/8	B812-5	34754			
			1	B48-8	34582			3/4	B812-6	34756			
			1-1/4	B48-10	34584			7/8	B812-7	34758			
			3/8	B56-3	34586			1	B812-8	34760			
	1/4 .252	5/16 .314	1/2	B56-4	34588		1-1/8	B812-9	34762	13/16 .815	1-1/4	B812-10	34764
			5/8	B56-5	34590		1-1/2	B812-12	34766				
			3/4	B56-6	34592		1-3/4	B812-14	34768				
			7/8	B56-7	34594		2	B812-16	34770				
			1	B56-8	34596		1/2	B813-4	34772				
1/4 .252		7/16 .439	1-1/4	B57-10	34612	3/4	B813-6	34774	7/8 .878	1	B813-8	34776	
			1-3/8	B57-11	34614	1-1/2	B813-12	34778					
			1/4	B57-2	34598	1/2	B814-4	34780					
			3/8	B57-3	34600	5/8	B814-5	34782					
			1/2	B57-4	34602	3/4	B814-6	34784					
	1/4 .252	1/2 .502	5/8	B57-5	34604	7/8	B814-7	34786	9/16 .565	1	B814-8	34788	
			3/4	B57-6	34606	1-1/4	B814-10	34790					
			7/8	B57-7	34608	1-1/2	B814-12	34792					
			1	B57-8	34610	3/4	B816-6	13585					
			1-1/4	B57-10	34612	1	B816-8	13587					
1/4 .252		3/8 .377	1-3/8	B57-11	34614	1-1/2	B816-12	13589	11/16 .690	2	B816-16	13591	
			3/8	B58-3	34616	1/2	B911-4	34794					
			1/2	B58-4	34618	3/4	B911-6	34796					
			5/8	B58-5	34620	1	B911-8	34798					
			3/4	B58-6	34622	1-1/2	B911-12	34800					
	1/4 .252	1/2 .502	7/8	B58-7	34624	3/8 .377	9/16 .565	1	B67-4	13577			
			1	B58-8	34626			1/2	B67-5	13579			
			1-1/4	B58-10	34628			3/4	B67-6	13581			
			1-1/2	B58-12	34630			1	B67-8	13583			
			1-3/4	B58-14	34632			3/8	B68-3	34634			
1/4 .252		7/16 .440	1/2	B67-4	13577		1/2	B68-4	34636	1/2 .502	5/8	B68-5	34638
			5/8	B67-5	13579		3/4	B68-6	34640				
			3/4	B67-6	13581		7/8	B68-7	34642				
			1	B67-8	13583		1	B68-8	34644				
			1/2	B68-3	34634		1-1/4	B68-10	34646				

On A and B dimensions, tolerances apply to actual (decimal) dimensions.



BOST-BRONZ Oil-Impregnated Sintered Bronze Bearings

ALL DIMENSIONS IN INCHES
ORDER BY CATALOG NUMBER OR ITEM CODE

Plain Cylindrical Bearings

A	B	C	Catalog Number	Item Code	
9/16 .565	3/4 .753	1/2	B912-4	34802	
		3/4	B912-6	34804	
		1	B912-8	34806	
	13/16 .815	1	1-1/2	B912-12	34808
			1/2	B913-4	34810
			3/4	B913-6	34812
5/8 .627	3/4 .753	1	B913-8	34814	
		1-1/4	B913-10	34816	
		1-1/2	B913-12	34818	
		1/2	B1012-4	34820	
		5/8	B1012-5	34822	
		3/4	B1012-6	34824	
	13/16 .815	1	7/8	B1012-7	34826
			1	B1012-8	34828
			1-1/8	B1012-9	34830
			1-1/4	B1012-10	34834
			1-1/2	B1012-12	34832
			1/2	B1013-4	34836
5/8 .627	13/16 .815	5/8	B1013-5	34838	
		3/4	B1013-6	34840	
		7/8	B1013-7	35400	
		1	B1013-8	34842	
		1-1/4	B1013-10	34844	
		1-1/2	B1013-12	34846	
	7/8 .878	2	1/2	B1013-16	34848
			5/8	B1014-5	34850
			3/4	B1014-6	34852
			7/8	B1014-7	34854
			1	B1014-8	34856
			1-1/4	B1014-10	34858
5/8 .628	1 1.003	1-1/2	B1014-12	34860	
		1-3/4	B1014-14	34862	
		2	B1014-16	34864	
		1/2	B1016-4	34866	
		5/8	B1016-5	34868	
		3/4	B1016-6	34870	
	11/16 .690	7/8 .878	7/8	B1016-7	34872
			1	B1016-8	34874
			1-1/4	B1016-10	34876
			1-1/2	B1016-12	34878
			1-3/4	B1016-14	34880
			2	B1016-16	34882
3/4 .753	7/8 .878	3/4	B1114-6	34884	
		1	B1114-8	34886	
		1-1/4	B1114-10	34888	
		1-1/2	B1114-12	34890	
		1-3/4	B1114-14	34892	
		2	B1114-16	34894	
	15/16 .9405	1	1/2	B1214-4	34896
			5/8	B1214-5	34898
			3/4	B1214-6	34900
			7/8	B1214-7	34902
			1	B1214-8	34904
			1-1/4	B1214-10	34906
1 1.004	15/16 .9405	1-1/2	B1214-12	34908	
		1-5/8	B1214-13	34910	
		1/2	B1215-4	34912	
		5/8	B1215-5	34914	
		3/4	B1215-6	34916	
		7/8	B1215-7	34918	
	1 1.003	1	1	B1215-8	34920
			1-1/4	B1215-10	34922
			1-1/2	B1215-12	34924
			1-3/4	B1215-14	34926
			2	B1215-16	34928
			1/2	B1216-4	34930
1 1.003	1	5/8	B1216-5	34932	
		3/4	B1216-6	34934	
		7/8	B1216-7	34936	
		1	B1216-8	34938	
		1-1/8	B1216-9	34940	
		1-1/4	B1216-10	34942	
	13/16 .815	1	1-1/2	B1216-12	34944
			1-3/4	B1216-14	34946
			2	B1216-16	34948
			2-1/2	B1216-20	34950

A	B	C	Catalog Number	Item Code	
3/4 .753	1-1/8 1.128	1/2	B1218-4	34952	
		3/4	B1218-6	34954	
		1	B1218-8	34956	
		1-1/4	B1218-10	34958	
		1-1/2	B1218-12	34960	
		1-3/4	B1218-14	34962	
	1-1/4 1.253	2	1-3/4	B1218-16	34964
			3/4	B1220-6	34966
			1	B1220-8	34968
			1-1/4	B1220-10	34970
			1-1/2	B1220-12	34972
			1-3/4	B1220-14	34974
13/16 .8155	1 1.003	2	B1220-16	34976	
		3/4	B1316-6	34978	
		1	B1316-8	34980	
		1-1/4	B1316-10	34982	
		1-1/2	B1316-12	34984	
		1-3/4	B1316-14	34986	
	1 1.003	2	2	B1316-16	34988
			3/4	B1416-6	34990
			7/8	B1416-7	34992
			1	B1416-8	34994
			1-1/4	B1416-10	34996
			1-1/2	B1416-12	34998
7/8 .878	1-1/8 1.128	3/4	B1418-6	35000	
		7/8	B1418-7	35002	
		1	B1418-8	35004	
		1-1/8	B1418-9	35006	
		1-1/4	B1418-10	35008	
		1-3/8	B1418-11	35010	
	1-1/4 1.253	2	1-1/2	B1418-12	35012
			1-3/4	B1418-14	35014
			2	B1418-16	35016
			2-1/2	B1418-20	35018
			3/4	B1420-6	35020
			1	B1420-8	35022
15/16 .9405	1-3/16 1.1905	1-1/4	B1420-10	35024	
		1-1/2	B1420-12	35026	
		2	B1420-16	35028	
		3/4	B1519-6	35030	
		1	B1519-8	35032	
		1-1/4	B1519-10	35034	
	1-1/4 1.253	2	1-1/2	B1519-12	35036
			2	B1519-16	35038
			3/4	B1520-6	35040
			1	B1520-8	35042
			1-1/4	B1520-10	35044
			1-1/2	B1520-12	35046
1 1.004	1-1/8 1.128	1-3/4	B1520-14	35048	
		2	B1520-16	35050	
		3/4	B1618-6	35052	
		1	B1618-8	35054	
		1-1/4	B1618-10	35056	
		1-1/2	B1618-12	35058	
	1-3/16 1.190	1	1-3/4	B1618-14	35060
			2	B1618-16	35062
			3/4	B1619-6	13593
			1	B1619-8	13595
			1-1/4	B1619-10	13597
			1-1/2	B1619-12	13599
1 1.004	1-1/4 1.253	1-3/4	B1619-14	13601	
		2	B1619-16	13603	
		3/4	B1620-6	35064	
		7/8	B1620-7	35066	
		1	B1620-8	35068	
		1-1/4	B1620-10	35070	
	1-5/16 1.3155	3	1-3/8	B1620-11	35072
			1-1/2	B1620-12	35074
			1-3/4	B1620-14	35076
			2	B1620-16	35078
			2-1/4	B1620-18	35080
			2-1/2	B1620-20	35082
1 1.003	2	3	B1620-24	35084	
		1	B1621-8	35086	
		1-1/4	B1621-10	35088	
		1-1/2	B1621-12	35090	
		1-3/4	B1621-14	35092	
		2	B1621-16	35094	
1 1.003	2	2-1/2	B1621-20	35096	
		3	B1621-24	35098	

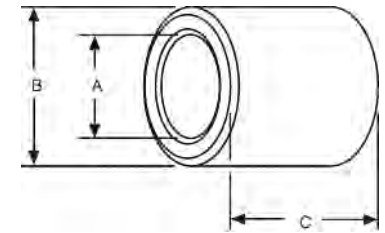

STANDARD TOLERANCES

DIMENSIONS	TOLERANCE	
A	1/8 - 1 1/2 1 3/4 - 2 1/2	+ .000, - .001 + .000, - .0015
B	2 3/4 - 3 1/2	+ .000, - .002
C	1/8 - 1 1/2 1 3/4 - 3 4	± .005 ± .0075 ± .010

CONCENTRICITY

DIMENSIONS	TOLERANCE	
A	1/8 - 1 1/2 1 5/8 - 3 3 1/4 - 3 1/2	.003 .004 .005

Prices on unlisted sizes and other Boston Gear powder metal parts provided on request.



On A and B dimensions, tolerances apply to actual (decimal) dimensions.

BOST-BRONZ Oil-Impregnated Sintered Bronze Bearings

Plain Cylindrical Bearings

F

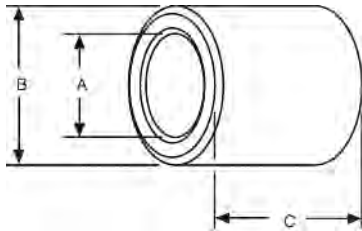

STANDARD TOLERANCES

DIMENSIONS		TOLERANCE
A	1/8 – 1 1/2	+ .000, – .001
	1 3/4 – 2 1/2	+ .000, – .0015
B	2 3/4 – 3 1/2	+ .000, – .002
	1/8 – 1 1/2	± .005
C	1 3/4 – 3	± .0075
	4	± .010

CONCENTRICITY

DIMENSIONS		TOLERANCE
A	1/8 – 1 1/2	.003
	1 5/8 – 3	.004
	3 1/4 – 3 1/2	.005

Prices on unlisted sizes and other Boston Gear powder metal parts provided on request.

ALL DIMENSIONS IN INCHES
ORDER BY CATALOG NUMBER OR ITEM CODE

A	B	C	Catalog Number	Item Code	A	B	C	Catalog Number	Item Code						
1 1.003	1-3/8 1.378	1	B1622-8	35100	1-7/16 1.4405	1-3/4 1.753	1	B2328-8	35252						
		1-1/4	B1622-10	35102			1-1/4	B2328-10	35254						
		1-1/2	B1622-12	35104			1-1/2	B2328-12	35256						
		1-3/4	B1622-14	35106			1-3/4	B2328-14	35258						
		2	B1622-16	35108			2	B2328-16	35260						
		2-1/2	B1622-20	35110			2-1/2	B2328-20	35262						
1-1/16 1.0655	1-5/16 1.3155	3	B1622-24	35112	1-1/2 1.503	1-3/4 1.753	3	B2328-24	35264						
		1	B1624-8	35114			1	B2428-8	35266						
		1-1/4	B1624-10	35116			1-1/4	B2428-10	35268						
		1-1/2	B1624-12	35118			1-1/2	B2428-12	35270						
		2	B1624-16	35120			2	B2428-16	35272						
		2-1/2	B1624-20	35122			2-1/2	B2428-20	35274						
1-1/8 1.129	1-5/16 1.3155	3	B1624-24	35124	1-5/8 1.628	1-7/8 1.878	3	B2428-24	35276						
		1	B1721-8	35126			1-13/16	B2429-12	35278						
		1-1/4	B1721-12	35128			1.816	B2429-24	35280						
		1-1/2	B1721-16	35130			1-1/2 1.503	1-7/8 1.878	3	B2430-12	35282				
		2-1/2	B1721-20	35132					2	B2430-16	35284				
		1-3/16 1.1905	1-1/2 1.503	1			B1820-8	13605	1-3/4 1.753	2-1/8 2.129	2	B2430-20	35286		
1-1/4	B1820-10			13639	3	B2430-24	35288								
1-1/2	B1820-12			13641	2 2.004	1-1/2 1.503	1	B2432-8			35290				
1	B1821-8			35134			1-1/2	B2432-12			35292				
1-1/4 1.254	1-5/8 1.628			1-1/2	B1821-10	35136	1-11/16 1.6905	2-3/16 2.191			2	B2432-16	35294		
				2	B1821-12	35138					2-1/2	B2432-20	35296		
				2-1/2	B1821-16	35140					3	B2432-24	35298		
				3/4	B1822-6	35142					1-5/8 1.628	1-7/8 1.878	1-1/4	B2630-10	35300
				1	B1822-8	35144							1-1/2	B2630-12	35302
				1-1/2 1.503	1-5/8 1.628	1-1/4					B1822-10	35146	1-3/4 1.753	2-1/2 2.004	2
1-1/2	B1822-12					35148	2-1/2	B2630-20			35306				
1-3/4	B1822-14					35150	3	B2630-24			35308				
2	B1822-16	35152	1-11/16 1.6905			2-3/16 2.191	1-1/4	B2735-14	35316						
2-1/2	B1822-20	35154					2	B2735-16	35318						
1-3/8 1.378	1-5/8 1.628	3	B1822-24			35156	2-1/4 2.254	2-3/4 2.754	3	B2735-24	35320				
		1	B1824-8	35158	4	B2735-32			35322						
		1-1/2	B1824-12	35160	1-3/4 1.753	2-1/8 2.129			2	B2832-16	35324				
		2	B1824-16	35162					2-1/2	B2832-20	35326				
		1-5/16 1.3155	1-5/8 1.628	1-1/4	B1923-10	35164			2-3/8 2.379	2-3/4 2.754	3	B2832-24	35328		
				1-1/2	B1923-16	35166					1-15/16 1.9405	2-5/16 2.316	1-1/2	B2834-12	35330
				2	B1923-20	35168							2	B2834-16	35332
				2-1/2	B1923-24	35170					3	B2834-24	35334		
				1	B1924-8	35172					2 2.003	2-1/2 2.504	2	B3137-16	35336
				1-1/4	B1924-10	35174							3	B3137-24	35338
		1-5/8 1.628	1-5/8 1.628	1-1/2	B1924-12	35176			2-1/2 2.504	3-1/4 3.255	4	B3137-32	35340		
				1-3/4	B1924-14	35178					1-11/16 1.6905	2-3/8 2.379	1-3/4	B3238-14	35342
2	B1924-16			35180	2	B3238-16	35344								
2-1/2	B1924-20			35182	2-3/4	B3238-22	35346								
3	B1924-24			35184	3	B3238-24	35348								
1-1/4 1.254	1-5/8 1.628			1	B2024-8	35186	2-1/2 2.504	3-1/2 3.505			4	B3238-32	35350		
				1-1/8	B2024-9	35188					2-1/4 2.254	2-3/4 2.754	1	B3240-8	35352
				1-1/4	B2024-10	35190							2	B3240-16	35354
				1-1/2	B2024-12	35192					3	B3240-24	35356		
				1-3/8	B2024-11	35192					2-3/8 2.379	2-3/4 2.754	2	B3644-16	35364
				1-1/2	B2024-12	35194							3	B3644-24	35366
1-5/16 1.3155	1-5/8 1.628			1-5/8	B2024-13	35196	2-3/8 2.379	2-3/4 2.754			4	B3644-32	35368		
		1-3/4	B2024-14	35198	2-1/2 2.504	3-1/4 3.255			2	B3844-16	35370				
		2	B2024-16	35200					3	B3844-24	35372				
		2-1/4	B2024-18	35202	4	B3844-32			35374						
		2-1/2	B2024-20	35204	2-1/2 2.504	3-1/4 3.255			2	B4048-16	35382				
		3	B2024-24	35206					3	B4048-24	35384				
1-3/8 1.378	1-5/8 1.628	1	B2226-8	35232	2-3/4 2.755	3-1/2 3.505	4	B4048-32	35386						
		1-1/2	B2226-12	35234			2-3/8 2.379	2-3/4 2.754	2	B4452-16	35388				
		2	B2226-16	35236					3	B4452-24	35390				
		2-1/2	B2226-20	35238			2-1/2 2.504	3-1/4 3.255	4	B4452-32	35392				
		3	B2226-24	35240					3 3.004	3-1/2 3.505	2	B4856-16	35394		
		1	B2228-8	35242			3	B4856-24			35396				
1-3/4 1.753	1-5/8 1.628	1-1/2	B2228-12	35244	3 3.004	3-1/2 3.505	4	B4856-32	35398						
		2	B2228-16	35246			2-3/8 2.379	2-3/4 2.754	2	B856-16	35242				
		2-1/2	B2228-20	35248					3	B856-24	35244				
		3	B2228-24	35250			4	B856-32	35246						

On A and B dimensions, tolerances apply to actual (decimal) dimensions.



BOST-BRONZ Oil-Impregnated Sintered Bronze Bearings

Flanged Type

ALL DIMENSIONS IN INCHES
ORDER BY CATALOG NUMBER OR ITEM CODE

A	B	C	D	E	Catalog Number	Item Code			
1/8 .127	5/16 .315	1/4 3/8	.375	3/64	FB25-2 FB25-3	35516 35518			
3/16 .189	5/16 .3145	1/8 1/4 3/8	.375	3/64	FB35-1 FB35-2 FB35-3	35520 35522 35524			
1/4 .252	3/8 .377	1/4 3/8 1/2 5/8 3/4	.500	3/64	FB46-2 FB46-3 FB46-4 FB46-5 FB46-6	35526 35528 35530 35532 35534			
5/16 .314	3/8 .377	3/8	.500	3/64	FB56-3	35536			
	7/16 .439	3/8	.625	3/32	FB57-3	35538			
		1/2			FB57-4	69191			
		5/8			FB57-5	69192			
		3/4			FB57-6	35540			
		7/8			FB57-7	69193			
	1	FB57-8	69194						
	1/2 .502	3/8 1/2 5/8	.688	3/32	FB58-3 FB58-4 FB58-5	35542 35544 35546			
3/8 .377	1/2 .502	3/8	.688	3/32	FB68-3	35548			
		13/32			FB68-3 1/4	35550			
		1/2			FB68-4	35552			
		5/8			FB68-5	35554			
		3/4			FB68-6	35556			
	7/8	FB68-7	69195						
	1	FB68-8	35558						
	1-1/4	FB68-10	35560						
	9/16 .5645	1/2 3/4 1-1/4	1/2	.750	1/8	FB69-4	69196		
			3/4			FB69-6	35562		
1-1/4			FB69-10			35564			
5/8 .627	3/8 1/2 5/8 3/4 1 1-1/4	3/8	.875	1/8	FB610-3	69197			
		1/2			FB610-4	35566			
		5/8			FB610-5	39198			
		3/4			FB610-6	35568			
		1			FB610-8	69199			
1-1/4	FB610-10	35570							
3/4 .753	1/2	1/2	1.000	1/8	FB612-4	35572			
		3/4							
		1-1/4							
7/16 .439	9/16 .565	1/2	.688	1/16	FB79-4	13611			
		5/8			FB79-5	13613			
		3/4			FB79-6	13615			
	5/8 .628	5/8 3/4 1-1/4	5/8	.875	1/8	FB710-5	35574		
			3/4			FB710-6	69200		
			1-1/4			FB710-10	35576		
1/2 .502	5/8 .628	1/2	.875	1/8	FB810-4	35578			
		5/8			FB810-5	35580			
		3/4			FB810-6	35582			
		7/8			FB810-7	69201			
		1			FB810-8	35584			
		1-1/4			FB810-10	35586			
		1-1/2			FB810-12	35588			
	1-3/4	FB810-14	35590						
	11/16 .690	1/2 5/8 3/4	1/2	.938	1/8	FB811-4	35592		
			5/8			FB811-5	69202		
			3/4			FB811-6	35594		
		3/4 .753	1/2			1.000	1/8	FB812-4	35596
			5/8					FB812-5	69203
			3/4					FB812-6	35598
7/8			FB812-7					35600	
1 1-1/4 1-1/2	1	1.000	1/8	FB812-8	35602				
	1-1/4			FB812-10	35604				
	1-1/2			FB812-12	35606				
9/16 .565	3/4 .753	1/2	1.000	1/8	FB912-4	69204			
		3/4			FB912-6	69205			
		1			FB912-8	35608			

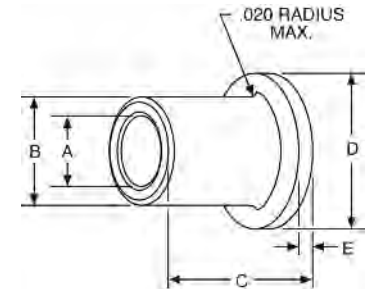

STANDARD TOLERANCES

DIMENSIONS	TOLERANCE	
A	1/8 - 1 1/2 1 3/4 - 2 1/2	+ .000, - .001 + .000, - .0015
B	2 3/4 - 3 1/2	+ .000, - .002
C	1/8 - 1 1/2	± .005
	1 3/4 - 3	± .0075
	4	± .010
D	3/8 - 1 1/4	± .005
	1 3/8 - 2 1/2	± .010
	4	± .015
E	3/8 - 1 1/4	± .0025
	1 3/8 - 2 1/2	± .005
	4	± .010

CONCENTRICITY

DIMENSIONS	TOLERANCE	
A	1/8 - 1 1/2	.003
	1 5/8 - 3	.004
	3 1/4 - 3 1/2	.005

Prices on unlisted sizes and other Boston Gear powder metal parts provided on request.



On A and B dimensions, tolerances apply to actual (decimal) dimensions.

BOST-BRONZ Oil-Impregnated Sintered Bronze Bearings

Flanged Type

F

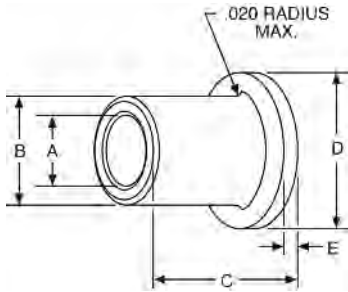

STANDARD TOLERANCES

DIMENSIONS	TOLERANCE
A 1/8 - 1 1/2 1 3/4 - 2 1/2	+ .000, - .001 + .000, - .0015
B 2 3/4 - 3 1/2	+ .000, - .002
C 1/8 - 1 1/2 1 3/4 - 3 4	± .005 ± .0075 ± .010
D 3/8 - 1 1/4 1 3/8 - 2 1/2 4	± .005 ± .010 ± .015
E 3/8 - 1 1/4 1 3/8 - 2 1/2 4	± .0025 ± .005 ± .010

CONCENTRICITY

DIMENSIONS	TOLERANCE
A 1/8 - 1 1/2 1 5/8 - 3 3 1/4 - 3 1/2	.003 .004 .005

Prices on unlisted sizes and other Boston Gear powder metal parts provided on request.

ALL DIMENSIONS IN INCHES
ORDER BY CATALOG NUMBER OR ITEM CODE

A	B	C	D	E	Catalog Number	Item Code		
5/8 .626	3/4 .753	1/2	1.000	1/8	FB1012-4	35610		
		5/8			FB1012-5	35612		
		3/4			FB1012-6	35614		
		1			FB1012-8	35616		
		1-1/4			FB1012-10	35618		
5/8 .627	13/16 .815	5/8	1.063	5/32	FB1013-5	69206		
		3/4			FB1013-6	35620		
		1			FB1013-8	35622		
		1-1/4			FB1013-10	35624		
		1-7/16			FB1013-11 1/2	35626		
	1-1/2	FB1013-12	35628					
	2	FB1013-16	35630					
	7/8 .878	1 1.003	5/8	1.125	5/32	FB1014-5	69207	
			3/4			FB1014-6	35632	
			1			FB1014-8	35634	
1-3/4	FB1014-14	35636						
3/4 .752	1 1.003	3/4	1.250	5/32	FB1016-6	69208		
		1			FB1016-8	35638		
		1-1/4			FB1016-10	35640		
	7/8 .878	1 1.003	3/4	1.125	5/32	FB1214-6	35644	
			1			FB1214-8	35646	
			1-1/4			FB1214-10	69209	
	15/16 .940	1 1.003	1	1.188	5/32	FB1215-8	35648	
			1-1/4			FB1215-10	69213	
			1-1/2			FB1215-12	35650	
		5/8 3/4	1 1.003	5/8	1.250	5/32	FB1216-5	69214
				3/4			FB1216-6	35652
				1			FB1216-8	35654
1-1/4	FB1216-10	35656						
1-1/2	FB1216-12	35658						
2	FB1216-16	35660						
7/8 .877	1 1.003	3/4	1.250	5/32	FB1416-6	35662		
		1			FB1416-8	69210		
		1-1/4			FB1416-10	35664		
1-1/8 1.128	1 1.128	1	1.375	5/32	FB1418-8	35666		
		1-1/4			FB1418-10	69211		
		1-1/2			FB1418-12	35668		
1 1.002	1-1/4 1.253	3/4	1.500	3/16	FB1620-6	35672		
		1			FB1620-8	35674		
	1-1/4	1-1/4	1.625	3/16	FB1620-10	35676		
	1-1/2	2			FB1620-12	35678		
1-3/8 1.378	1-1/2 1.378	1-3/4	1.625	3/16	FB1620-16	35680		
1-1/8 1.127	1-3/8 1.377	3/4	1.750	1/8	FB1822-6	13617		
		1			FB1822-8	13619		
		1-1/4			FB1822-10	13621		
1-1/4 1.252	1-1/2 1.503	1	1.750	3/16	FB2024-8	69216		
		1-1/4			FB2024-10	35686		
		1-1/2			FB2024-12	69217		
1-3/8 1.377	1-5/8 1.628	3/4	2.000	1/8	FB2226-6	13623		
		1			FB2226-8	13625		
1-1/2 1.503	1-3/4 1.754	1-1/2	2.063	3/16	FB2428-12	35688		
		2			FB2428-12	35688		
2 2.003	2-1/4 2.254	3/4	2.500	1/8	FB3236-6	13627		
		1			FB3236-8	13629		
		1-1/4			FB3236-10	13631		
2-3/4 2.752	3-1/4 3.255	1-1/2	4.000	3/16	FB4452-12	13635		

On A and B dimensions, tolerances apply to actual (decimal) dimensions.



BOST-BRONZ Oil-Impregnated Sintered Bronze Bearings

ALL DIMENSIONS IN INCHES
ORDER BY CATALOG NUMBER OR ITEM CODE

Thrust Type

A	B	C	Catalog Number	Item Code	A	B	C	Catalog Number	Item Code
1/4 .255	7/16 .4375	1/16	TB47	13515	3/4 .765	1-9/16 1.562	3/32	TB1225	35784
	1/2 .500	1/16	TB48	13517		1-3/4 1.750	1/8	TB1228	35786
	5/8 .625	1/16	TB410	35766	7/8 .8905	1-1/2 1.500	1/8	TB1424	35788
5/16 .315	5/8 .625	1/16	TB510	13519	7/8 .880	2 2.000	1/8	TB1432	13525
	3/4 .750	1/16	TB512	35768	7/8 .8905	2-1/8 2.125	1/8	TB1434	35790
3/8 .385	5/8 .625	1/16	TB610	13521	1	1-1/2 1.504	1/8	TB1624	35792
3/8 .380	3/4 .750	1/32	TB612	35770	1.003	1-1/2 1.500	3/16	TB1624-3	13527
	3/4 .750	1/8	TB612-2	13523	1 1.0155	1-5/8 1.625	1/4	TB1626-4	13529
7/16 .440	3/4 .750	1/16	TB712	69218	1 1.0120	1-3/4 1.750	1/8	TB1628	13531
1/2 .505	3/4 .750	1/16	TB812	35772	1 1.016	2 2.000	1/8	TB1632	35794
1/2 .505	7/8 .875	3/16	TB814	35774	1 1.0155	2-7/8 2.875	1/8	TB1646	13533
1/2 .510	1 1.000	1/16	TB816	35776	1-1/8 1.140	1-7/8 1.875	1/8	TB1830	13535
9/16 .565	1-1/4 1.250	1/8	TB920	35778	1-1/4 1.253	1-3/4 1.750	1/8	TB2028	35796
5/8 .628	1 1.000	1/8	TB1016	35780	1-1/4 1.265	2 2.000	1/8	TB2032	13537
	1-3/16 1.187	3/32	TB1019	35782	2-3/8 2.375	1/8	TB2038	13539	
	1-1/4 1.250	1/8	TB1020	69219	1-1/9 1.255	3-5/16 3.312	1/8	TB2053	13541
5/8 .6265	1-1/2 1.500	1/8	TB1024	69220	1-3/8 1.379	1-15/16 1.940	1/8	TB2231	13543
3/4 .753	1-1/4 1.250	1/8	TB1220	69221	1-1/2 1.503	2 2.000	1/8	TB2432	13545
	1-3/8 1.375	1/8	TB1222	69222	1-1/2 1.505	2-1/2 2.505	1/8	TB2440	13547
					1-1/2 1.510	3-1/2 3.500	3/16	TB2456	35798
					1-9/16 1.578	2-7/16 2.4375	1/8	TB2539	13549
					1-3/4 1.765	2-5/8 2.625	1/8	TB2842	13551
					2 2.011	3 3.000	1/4	TB3248	13553
					2 2.031	3-5/8 2.625	3/16	TB3258	13555
					2-1/16 2.062	4 4.000	1/8	TB3364	13557
					2-1/2 2.502	3-1/4 3.250	1/8	TB4052	13559

On A and B dimensions, tolerances apply to actual (decimal) dimensions.

BOST-BRONZ is stocked in this convenient Plate form for ease in machining to required bearing size or shape — at your service for all emergencies.

ALL DIMENSIONS IN INCHES
ORDER BY CATALOG NUMBER OR ITEM CODE

A	B	C	Catalog Number	Item Code
1/8 3/16 1/4 5/16	5	6	PB5602	35692
			PB5603	35694
			PB5604	35696
			PB5605	35698
3/8 1/2 5/8 3/4 1	5	6	PB5606	35700
			PB5608	35702
			PB5610	35704
			PB5612	35706
			PB5616	35708
3/16 1/4	5	8	PB5803	35710
			PB5804	35712

Keep **BOST-BRONZ** plate stock on hand for: Breakdowns – maintenance and repairs – Producing small lots of special sizes – Experimental and development work.

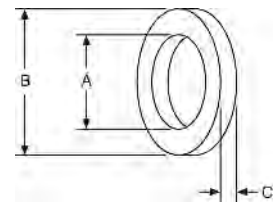

STANDARD TOLERANCES

DIMENSIONS	TOLERANCE
A	1/4 – 1 1/4 1 3/8 – 2 1/2
B	7/16 – 1 1/2 1 9/16 – 3 3 1/4 – 4
C	All

Plate Stock

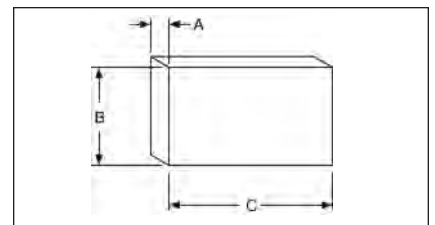
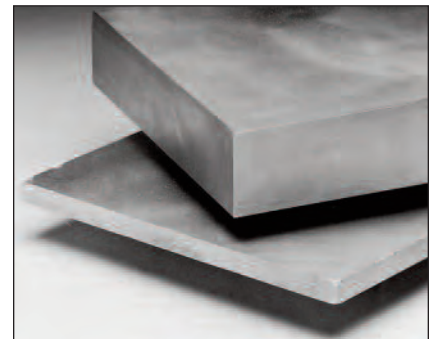

STANDARD TOLERANCES

DIMENSIONS	TOLERANCE
A	All

BOST-BRONZ Oil-Impregnated Sintered Bronze Bearings

Cored Bars

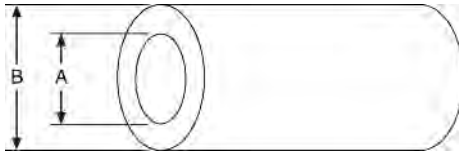

STANDARD TOLERANCES

DIMENSIONS		TOLERANCE
A	All	-1/8"
B	All	+1/8"

BOST-BRONZ is stocked in these convenient Bar forms for ease in machining to required bearing size or shape — at your service for all emergencies.

ALL DIMENSIONS IN INCHES ORDER BY CATALOG NUMBER OR ITEM CODE

A	B	Catalog Number	Item Code
1/2	1	CB816	35402
	1-1/4	CB820	35404
	1-1/2	CB824	35406
5/8	1	CB1016	35408
	1-1/4	CB1020	35410
	1-3/8	CB1022	35412
	1-1/2	CB1024	35414
	1-3/4	CB1028	35416
3/4	1-1/4	CB1220	35418
	1-1/2	CB1224	35420
	1-3/4	CB1228	35422
	2	CB1232	35424
	2-1/2	CB1240	35426
7/8	1-3/8	CB1422	35428
	1-1/2	CB1624	35430
1	1-3/4	CB1628	35432
	2	CB1632	35434
	2-1/4	CB1636	35436
	2-1/2	CB1640	35438
	3	CB1648	35440
	1-1/4	1-3/4	CB2028
2		CB2032	35444
2-1/4		CB2036	35446
2-1/2		CB2040	35448
3		CB2048	35450
1-3/8	2	CB2232	35452
	2	CB2432	35456
1-1/2	2-1/4	CB2436	35458
	2-1/2	CB2440	35460
	3	CB2448	35462
	3-1/2	CB2456	35464

A	B	Catalog Number	Item Code
1-3/4	2-1/4	CB2836	35466
	2-1/2	CB2840	35468
	2-3/4	CB2844	35470
	3	CB2848	35472
2	3-1/2	CB2856	35474
	2-3/4	CB3244	35476
	3	CB3248	35478
	3-1/4	CB3252	35480
	4	CB3264	35482
2-1/4	4-1/2	CB3272	35484
	5	CB3280	35486
	3	CB3648	35488
2-1/4	3-1/2	CB3656	35490
	3-3/4	CB3660	35492
2-3/8	3	CB3848	35494
2-1/2	3-1/2	CB4056	35496
	3-3/4	CB4860	35498
3	4	CB4864	35500
	5	CB4880	35502
	6	CB4896	35504
	4-3/4	CB5676	35506
3-1/2	4-3/4	CB5676	35506
4	6	CB6496	35512
5	7	CB80112	35514

All bars are 6 1/2" long.



Solid Bars

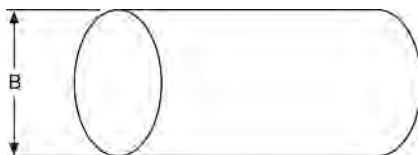

STANDARD TOLERANCES

DIMENSIONS		TOLERANCE
B	All	+ 1/8"

ALL DIMENSIONS IN INCHES ORDER BY CATALOG NUMBER OR ITEM CODE

B	Length	Catalog Number	Item Code
1/4	2	SB4	35714
3/8	3	SB6	35716
1/2	6-1/2	SB8	35718
5/8		SB10	35720
3/4		SB12	35722
7/8		SB14	35724
1	6-1/2	SB16	35726
1-1/8		SB18	35728
1-1/4		SB20	35730
1-3/8		SB22	35732
1-1/2	6-1/2	SB24	35734
1-5/8		SB26	35736
1-3/4		SB28	35738
2	6-1/2	SB32	35742
2-1/4		SB36	35744
2-1/2		SB40	35746
3		SB48	35748
3-1/2	6-1/2	SB56	35750
4		SB64	35752
4-1/2		SB72	35754
5		SB80	35756
5-1/2		SB88	35758
6	6-1/2	SB96	35760
7		SB112	35762
8		SB128	35764